

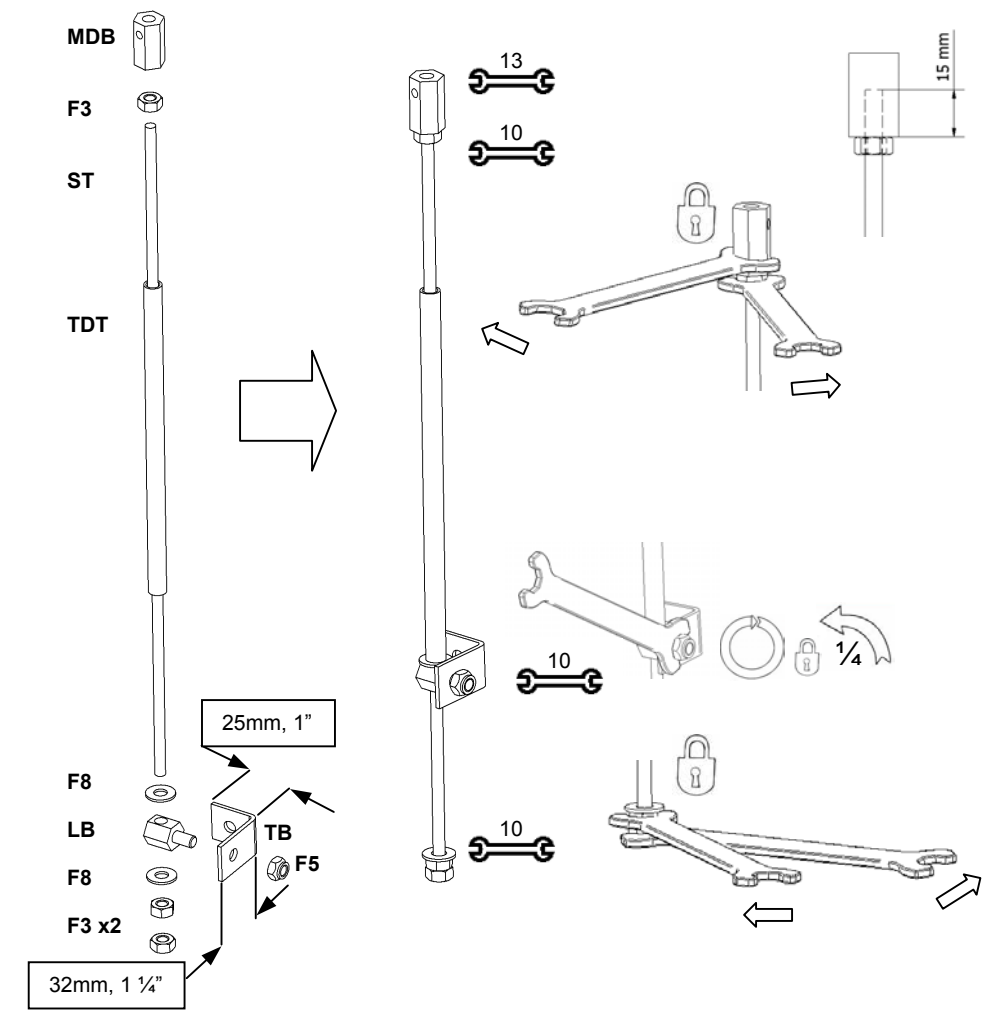

WARNING! PRODUCT MUST BE FULLY ASSEMBLED BEFORE CONNECTING TO THE ELECTRICITY SUPPLY - READ USER INSTRUCTIONS FULLY BEFORE CONNECTING TO ELECTRICITY SUPPLY - RISK OF ELECTRIC SHOCK!
ATTENTION! LE PRODUIT DOIT ETRE ENTIEREMENT ASSEMBLE AVANT D'ETRE BRANCHE - VEUILLEZ LIRE TOUT LE MODE D'EMPLOI AVANT DE LE BRANCHER - RISQUE DE DECHARGE!
ATTENCION! EL PRODUCTO DEBE SER MONTADO ENTERAMENTE ANTES DE SER CONECTADO AL SUMINISTRO DE ELECTRICIDAD - LEER ATENTAMENTE TODO EL MANUAL DE UTILIZACION ANTES DE CONECTARLE AL SUMINISTRO DE ELECTRICIDAD - RIESGO DE DESCARGA ELECTRICA

| | | | | | | | | |
|-----|--|---|-----|--|---|-----|------------------|----|
| FSL | | 1 | H | | 2 | TDT | | 1 |
| FSR | | 1 | HT | | 1 | TB | | 1 |
| BP | | 1 | TI | | 1 | DH | | 2 |
| RS | | 1 | BI | | 1 | F1 | M6 x 16 CARRIAGE | 14 |
| EE | | 1 | RP | | 1 | F2 | M8 Plain | 14 |
| RC | | 2 | SP | | 4 | F3 | M6 Plain | 30 |
| FF | | 1 | D | | 1 | F4 | M6 Spring | 14 |
| WT | | 1 | FT | | 4 | F5 | M6 Nyloc | 11 |
| TPC | | 1 | NC | | 4 | F6 | No.8 x 12 C/sunk | 8 |
| TCB | | 3 | ST | | 1 | F7 | No.8 x 12 | 30 |
| TL | | 1 | MDB | | 1 | F8 | M6 Plain | 3 |
| TC | | 3 | LB | | 1 | F9 | M6 x 15mm | 10 |
| | | | | | | F10 | M4 x 8mm | 1 |

1 SA1 -



2 SA2 - (X3)

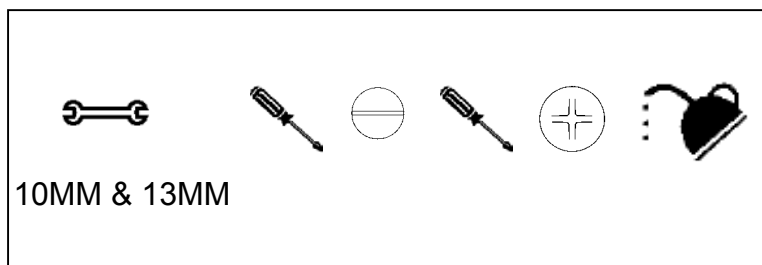
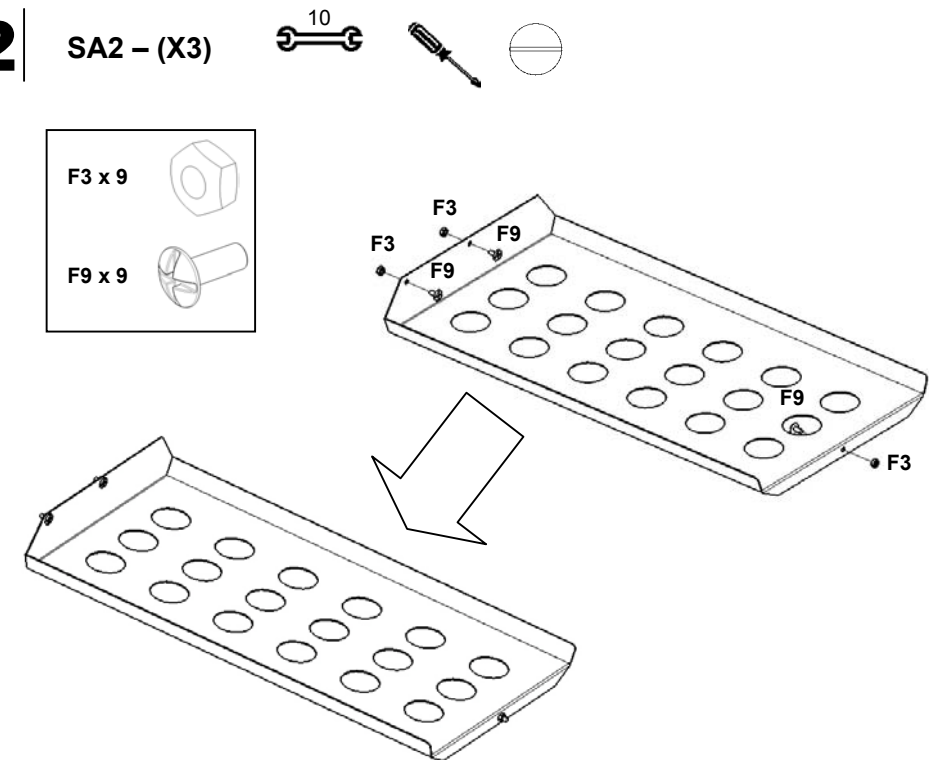

1/4

TIGHTEN THE FASTENER THEN RELEASE 1/4 OF A TURN
 BIEN SERRER LA VIS PUIS DESSERER D'UN QUART DE TOUR
 APRETAR EL TORNILLO BIEN FUERTE Y DESTORNILLAR UN CUARTO DE VUELTA
 ZIEHEN SIE DIE MUTTER FEST AN UND LÖSEN SIE DIESE ANSCHLIESSEND UM EINE VIERTEL UMDREHUNG
 APERTAR PARAFUSO FIRMEMENTE, DEPOIS DESAPERTAR 1/4 DE VOLTA

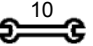

ACHTUNG! BEVOR DAS PRODUKT ANS NETZ ANGESCHLOSSEN WERDEN DARF, MUSS ES KOMPLETT MONTIERT WERDEN. LESEN SIE DIE BETRIEBSANLEITUNG SORGFÄLTIG DURCH, BEVOR SIE DAS PRODUKT IN BETRIEB NEHMEN UND ANS NETZ ANSCHLIESSEN - ES BESTEHT DIE GEFAHR EINES ELEKTRISCHEN SCHLAGES!
ATENÇÃO! ESTE PRODUCTO TEM QUE SER COMPLETAMENTE MONTADO ANTES DE LIGAR Á CORRENTE - LEIA AS INSTRUÇÕES NA TOTALIDADE, ANTES DE LIGAR Á CORRENTE - RISCO DE CHOQUE ELÉCTRICO!

3 |  10

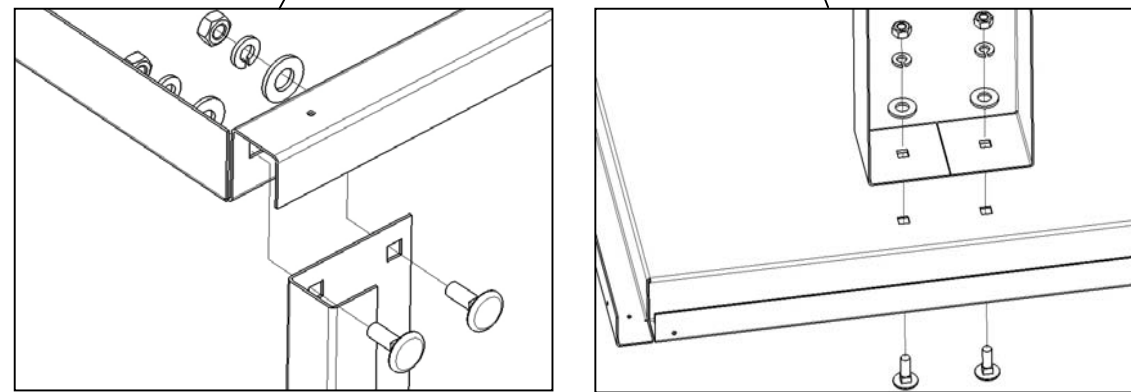
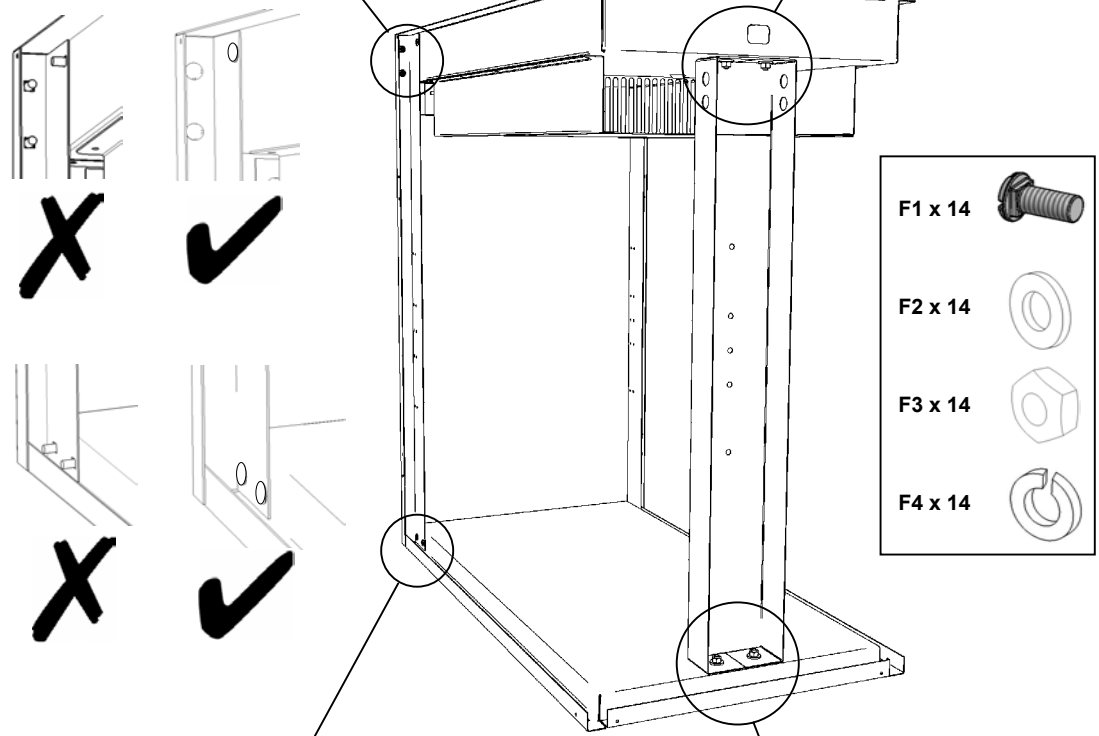
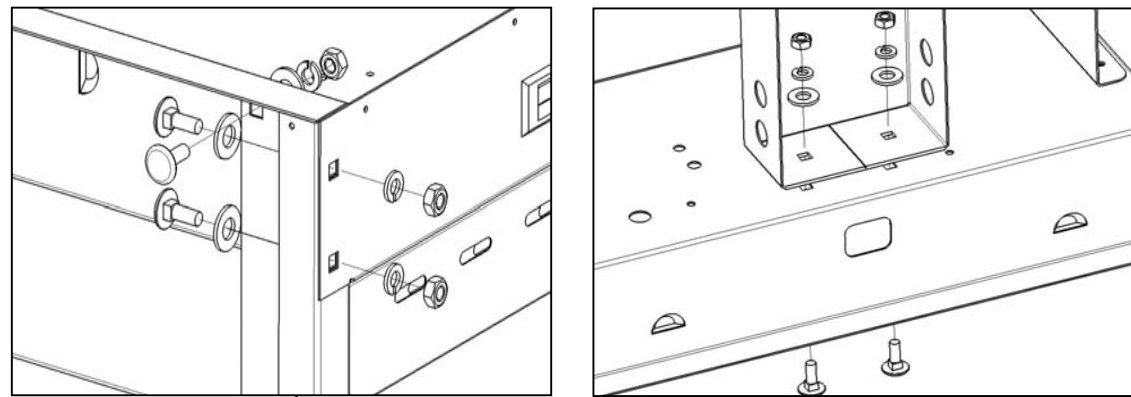

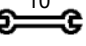
4 |  10

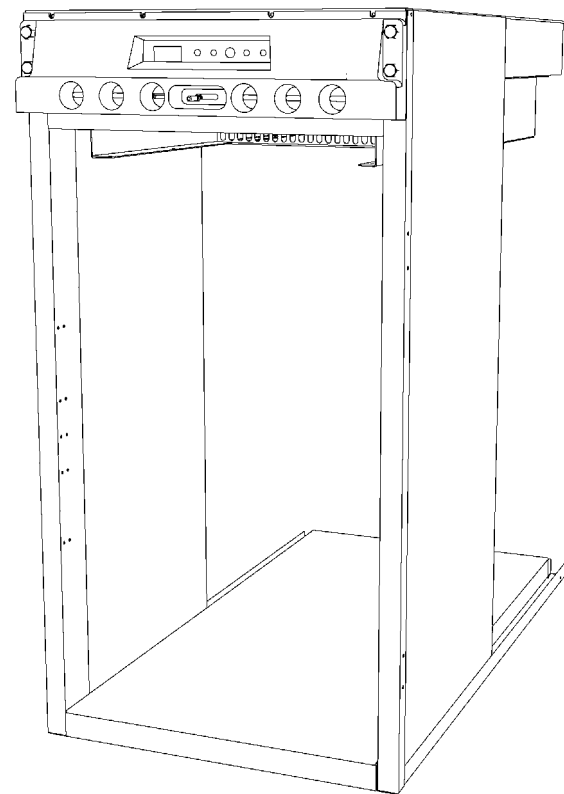
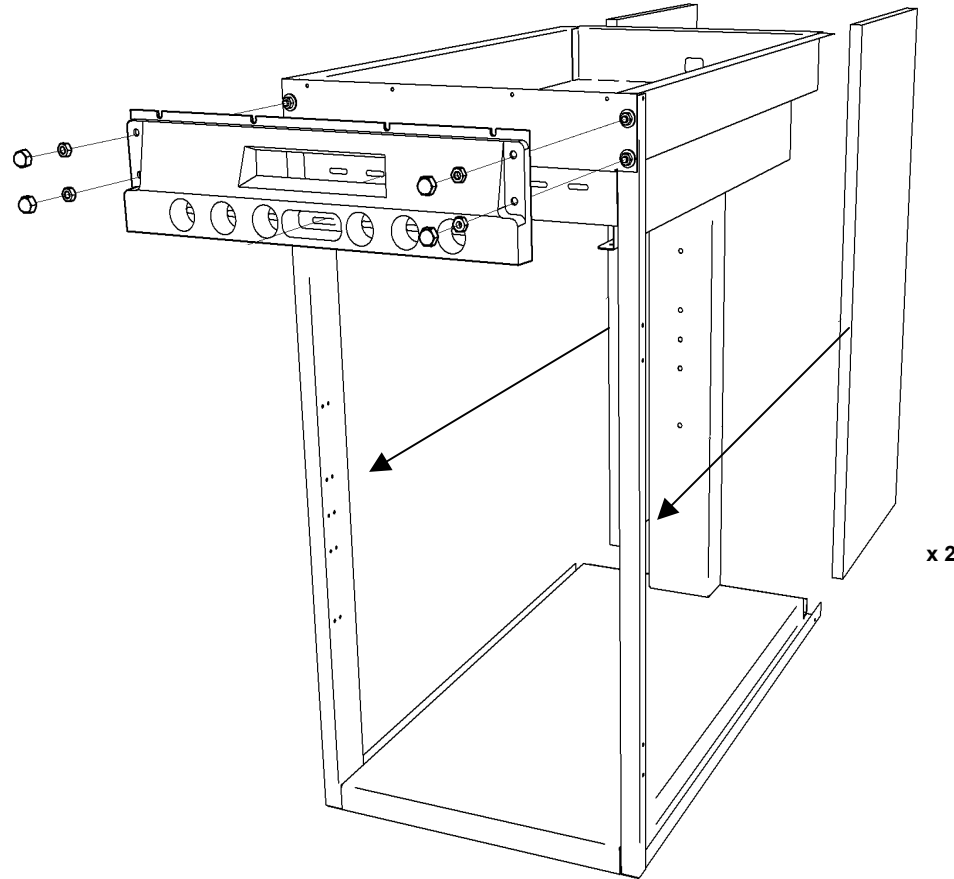
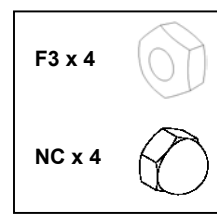

5 |  

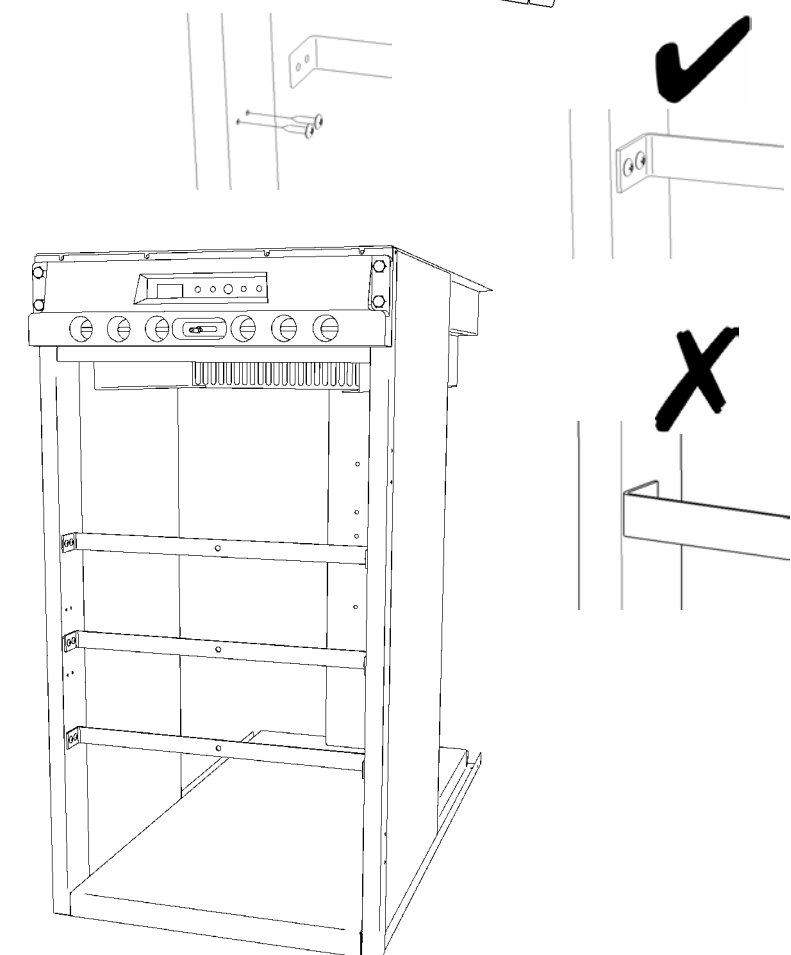
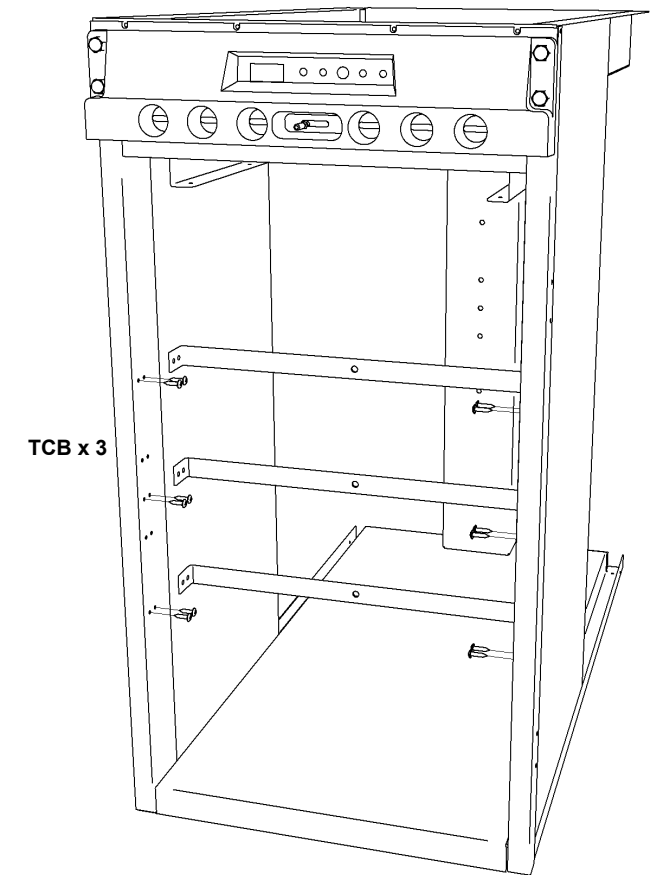
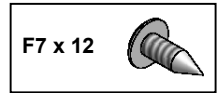

6

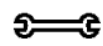

F5 x 9

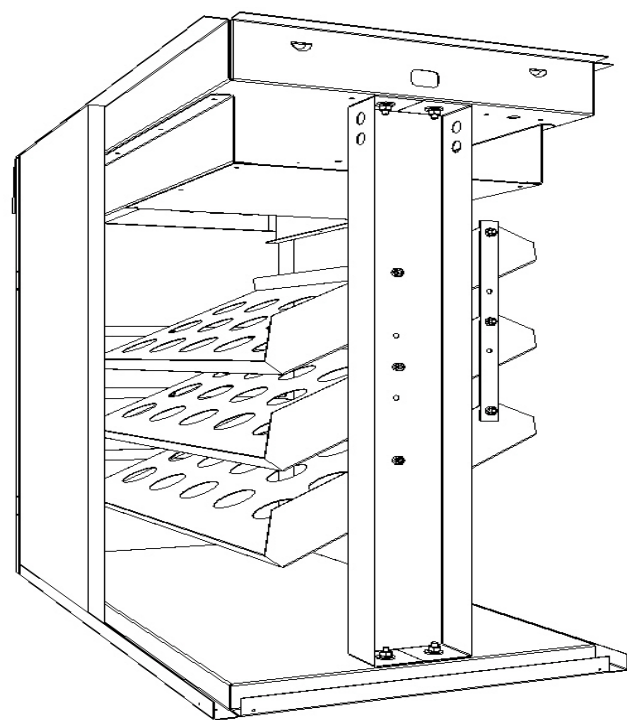
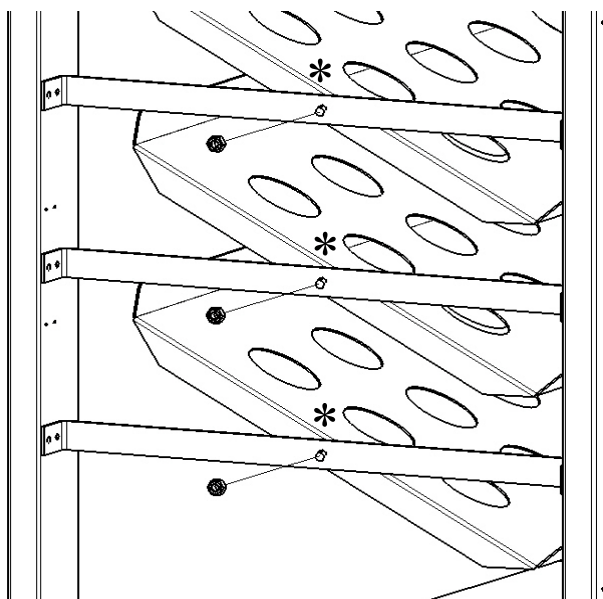
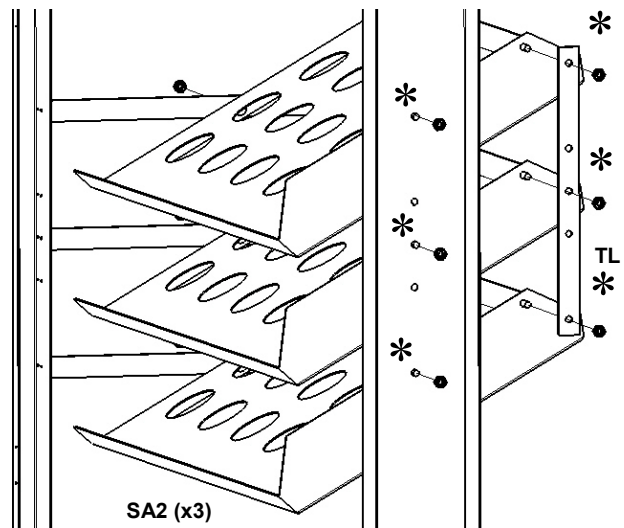

7

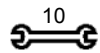

F5 x 1



F8 x 1



F9 x 1



F10 x 1

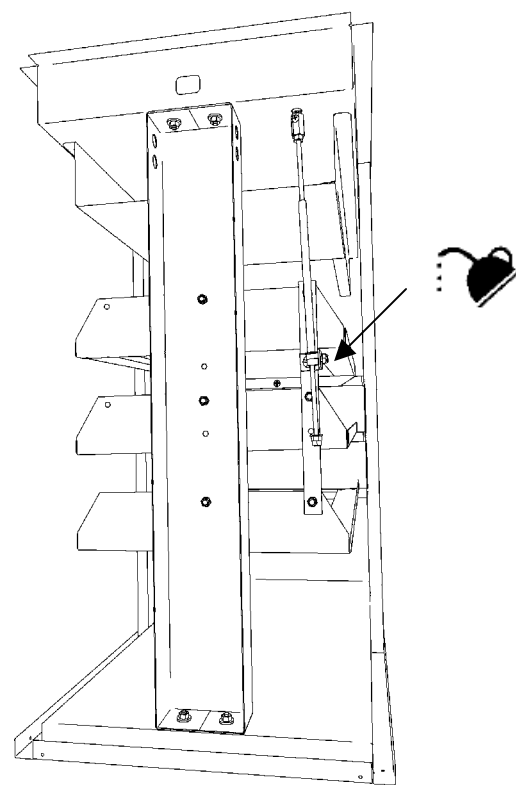
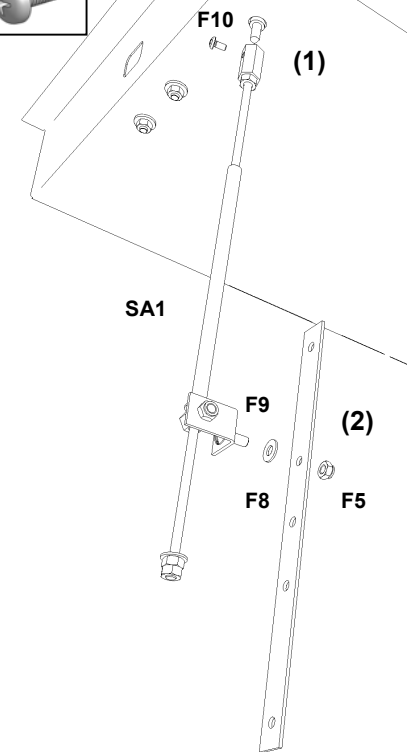

8

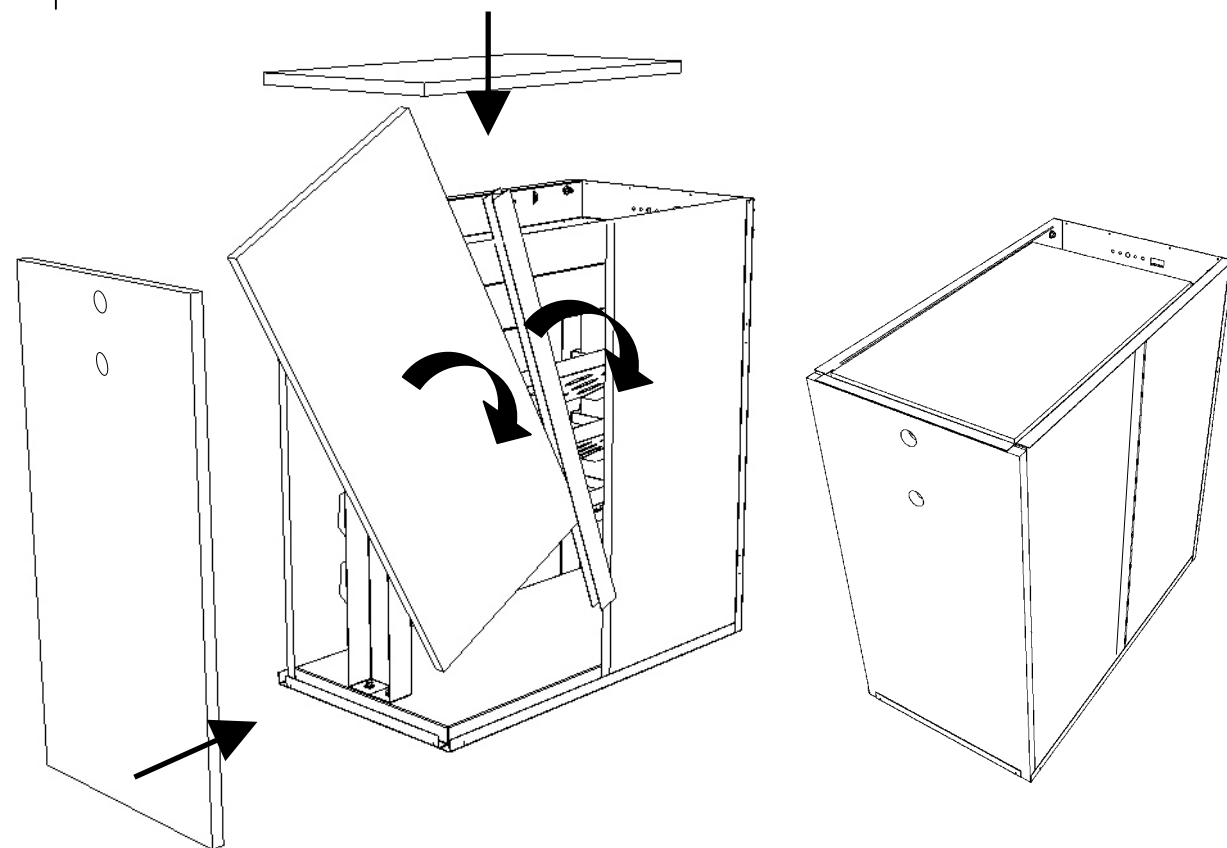

9



F7 x 14

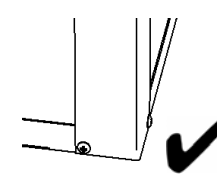
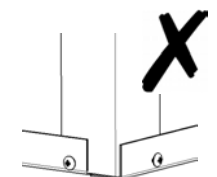
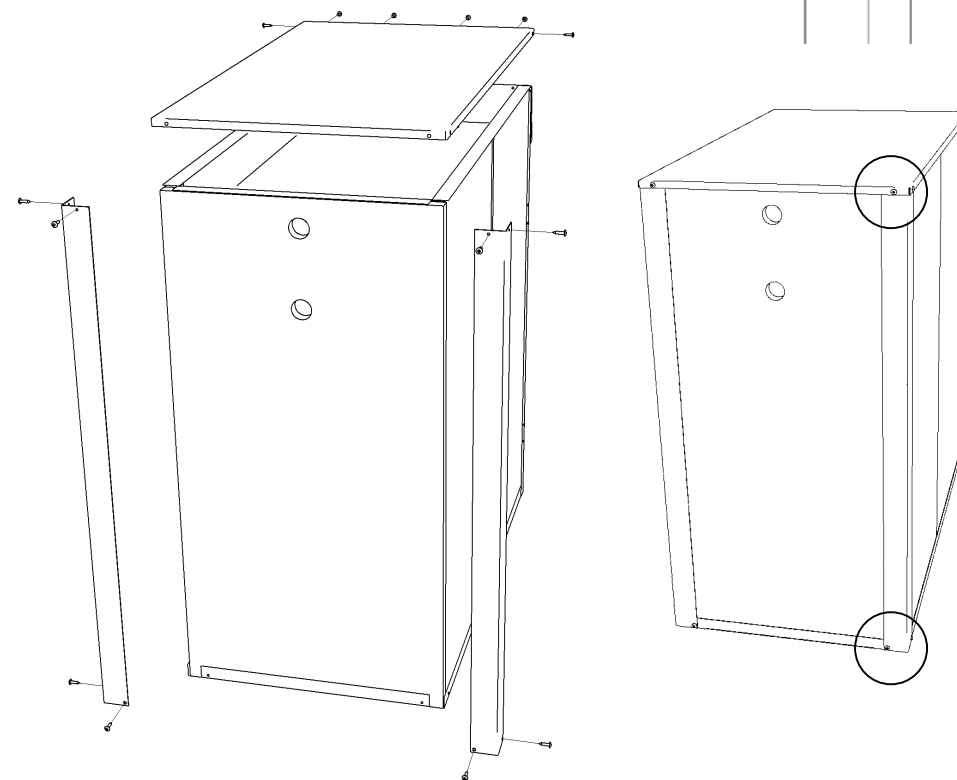
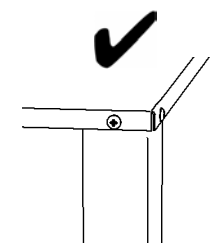
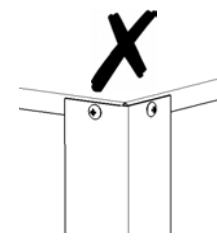

10

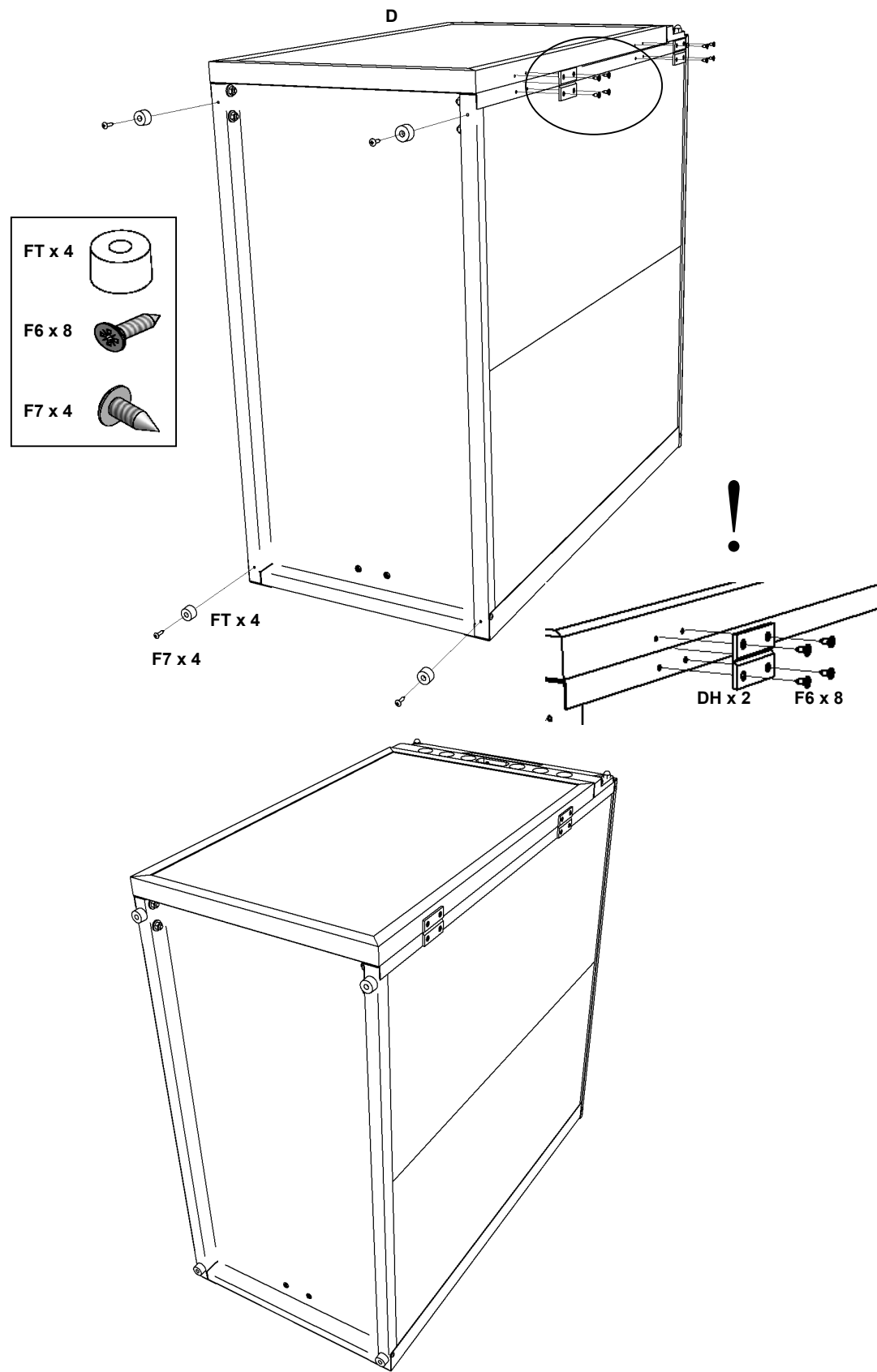

11

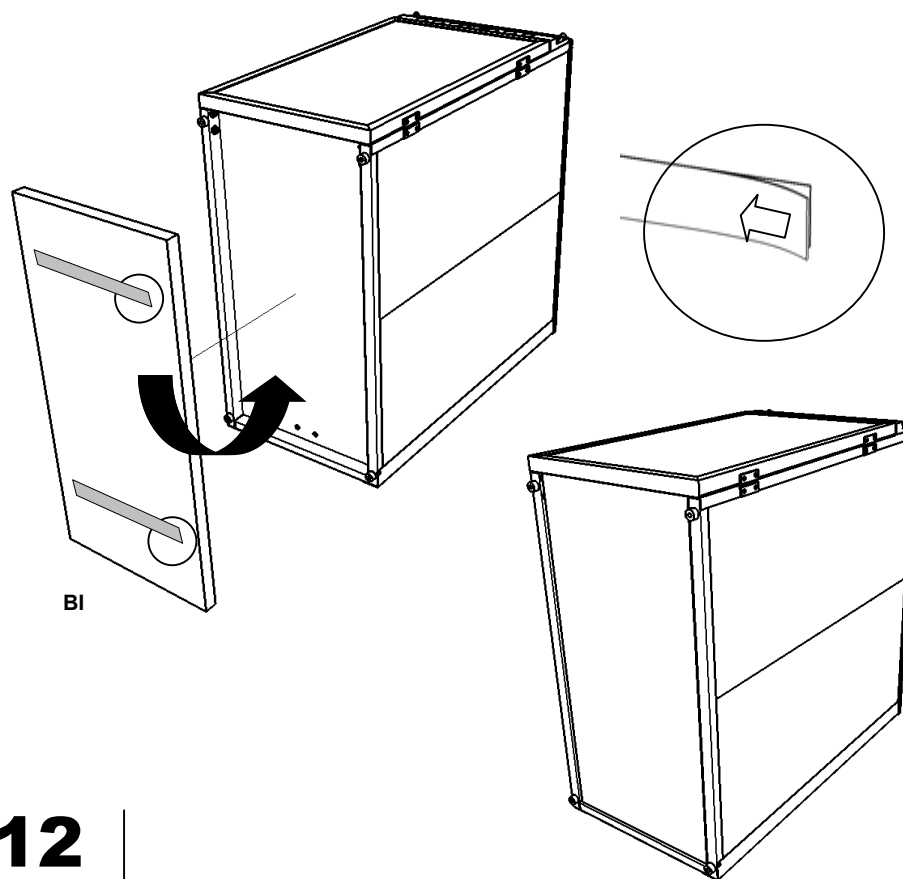

12

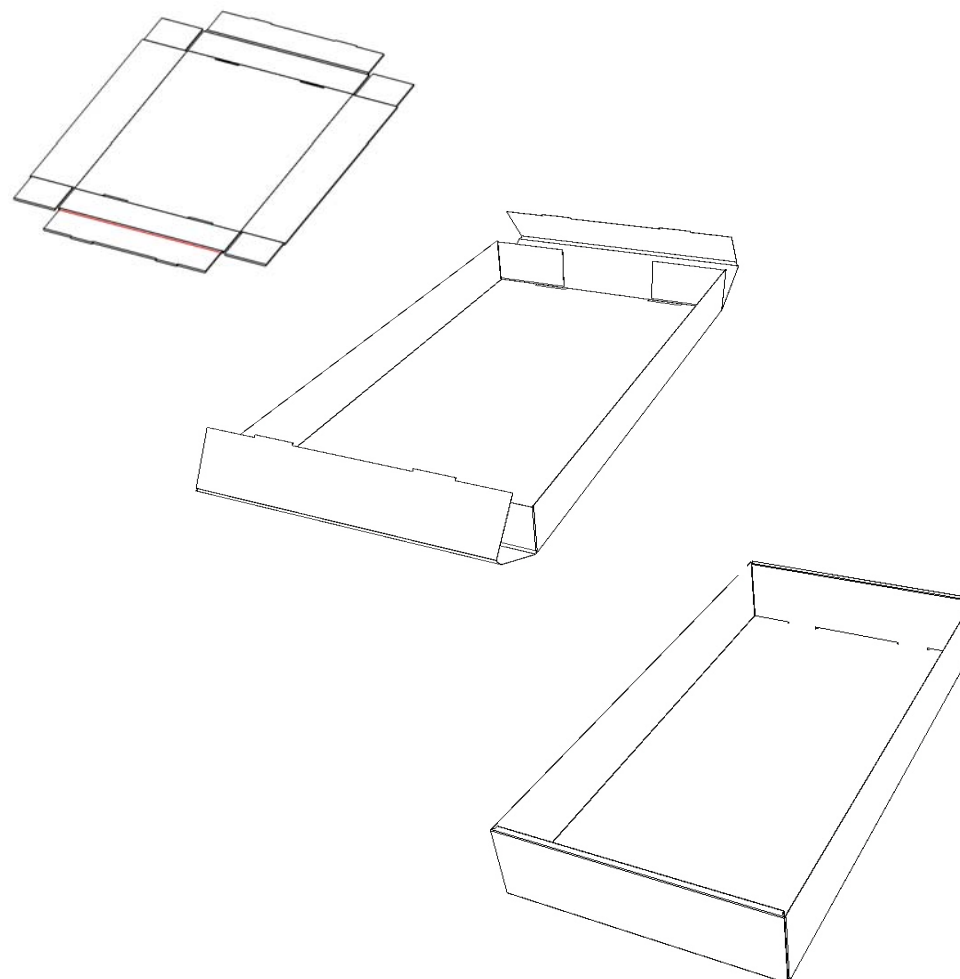

13

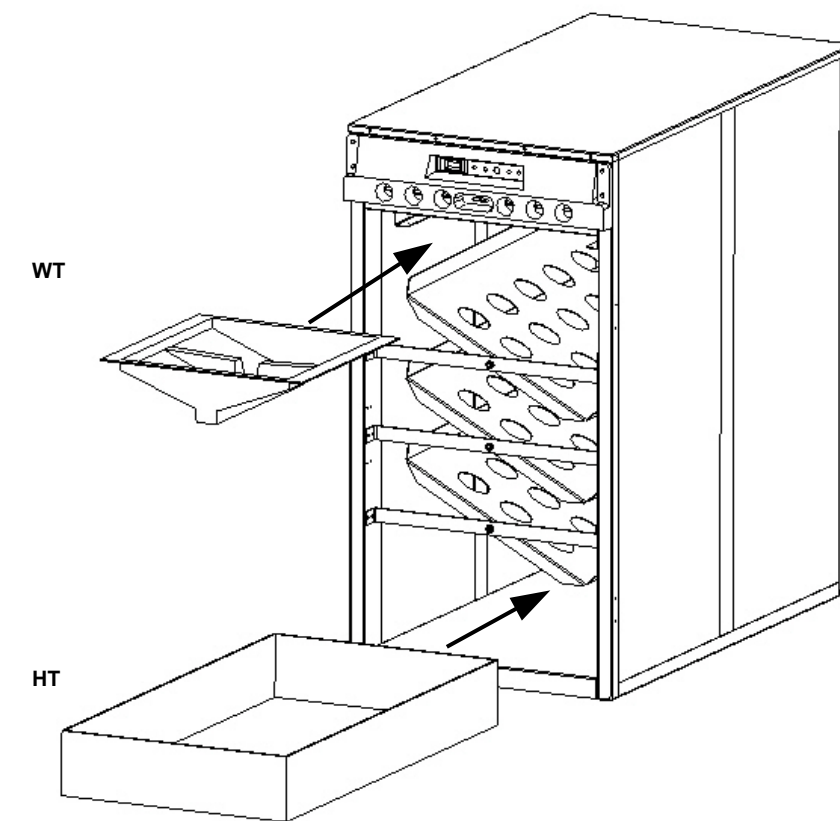

14

